



# Leigh Road Baptist Church BUILD project



## IT ALL STARTS HERE

Community | Education | Understanding | Fun





## Join us in changing lives in our community

We are delighted that every week hundreds of people use the premises of Leigh Road Baptist Church (LRBC) for a multitude of activities. We currently provide a coffee shop, community centre, auditorium, halls, retail outlets and warehouse facilities.

Alongside working with the elderly, we are heavily involved in early years development with our Pre-School. We have appreciative parents, excellent staff and externally recognised standards in teaching quality. However, we now need modern fit for purpose premises to deliver a complete service.

LRBC is transforming its complex by enhancing the Pre-School and community facilities. We are creating a contemporary, visible and inviting landmark that drives forward and builds upon over 100 years of services for the people of Leigh.



Will you help us?

*Steven*

Steven Hembery MA FCA  
Project Leader





“Enhancing the  
Pre-School and  
community facilities  
for all.”





## Transformed facilities, increased opportunities

Over recent years the entire island site has been secured by LRBC for community use. This prominent, prime, accessible location for the surrounding community now fronts onto the four surrounding roads.

We aim to develop new high quality premises that will provide facilities meeting the needs of the local population. This will allow us to enhance the services we provide for children, youth, families and the elderly within our community.

This will result in a healthy community creating more jobs and volunteering opportunities for local people.

We see this as the continuation of a long and sustained investment in the people and families of our neighbourhood.

- 1 1993 - Purchase of island site, opening of Oasis our community coffee house and provision of three flats, two of which provide for low-income families
- 2 2000 - Development and opening of The Stables function suite for the whole community
- 3 2009 - Upgrading and decoration of the auditorium for public performance
- 4 2011 - Development of pre-school facility, new main open glass entrance and sports and events hall enhancement



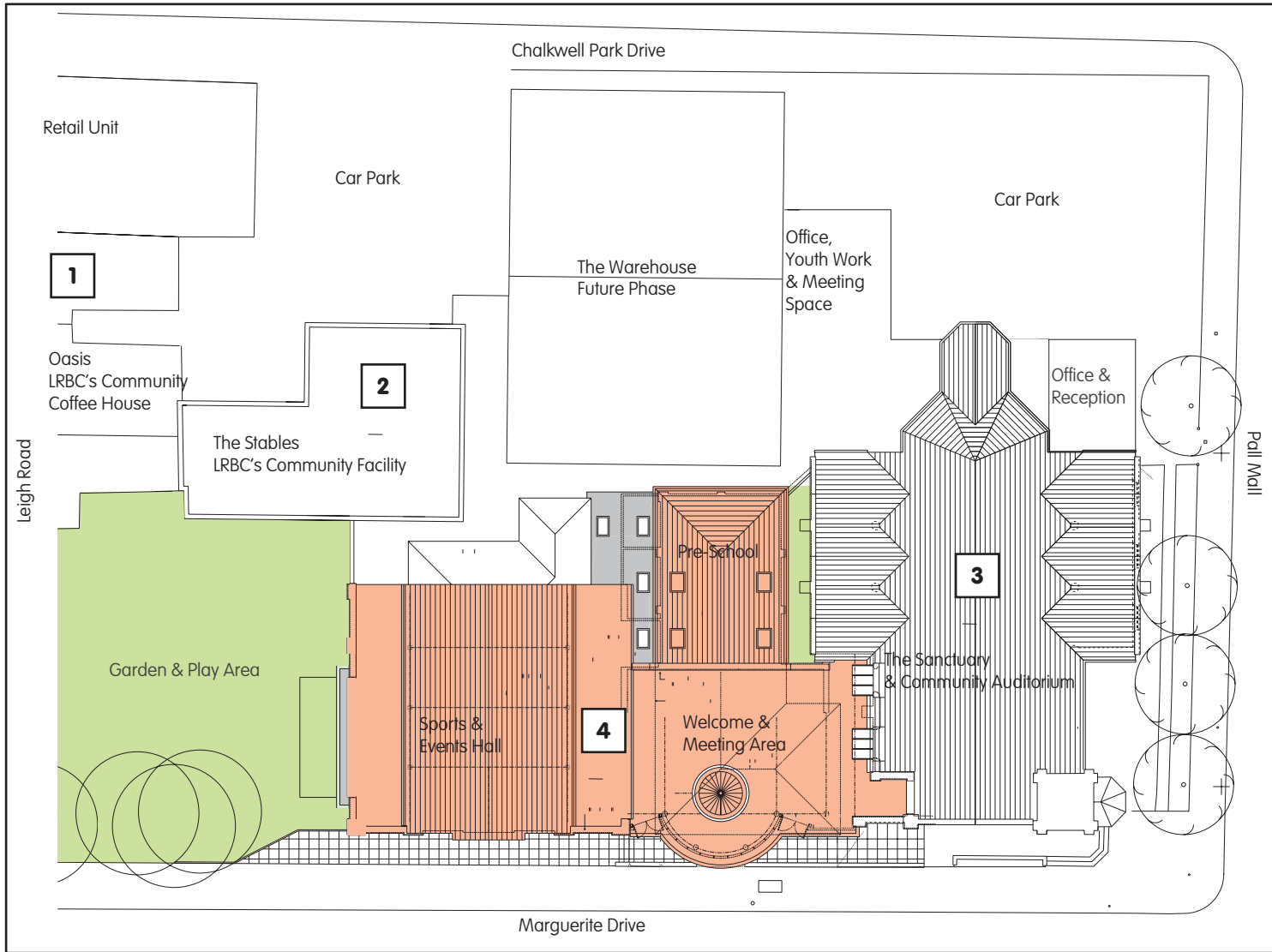



## Will you help us make these plans a reality?

### Who is Pre-School for?

Currently providing jobs for 16 members of staff, Pre-School is for children aged 2-5 years and caters for around 70 children and families per week. We aim to provide a secure, friendly atmosphere where children can learn and grow as individuals, and with confidence in their own abilities, leaving us for school with a well rounded early-years education. However, Pre-School also caters for the whole family and staff are often greatly involved in supporting and signposting services for parents and carers.

### Improving the safeguarding of children

The development will provide fit for purpose facilities, reducing risk in a self contained unit specifically designed with the children's safety and learning in mind. New direct and contained access to two outside play areas will also be created; aiding children who do not have safe access to outside play space in their home environment. The Pre-School, Youth and Children's work of LRBC take the issue of child protection very seriously. Our 'Safe to Grow' and the government's 'Safe from Harm' policies involve CRB checks, training, and risk assessments in order to improve security of both children and those working with them whilst on our premises.

### Who else will benefit from the project?

Once a week LRBC runs a toddler group that benefits over 150 families. This provides space for children to play safely and parents/carers to relax and meet with other adults. The new open welcome area, meeting spaces and bright and spacious hall facilities would also benefit youth & schools, community theatre, elderly and interest groups that frequent the premises weekly.

### How much is the Pre-School part of this development actually costing?

The figure for creating this fantastic Pre-School area, and the other areas they will benefit from, is in the region of £110,000.

### Surely the state provides for this?

No, in terms of building and facilities enhancement for Pre-School and other community activities there is no government funding. The vast majority of this project is being paid for by church members with over £600,000 pledged and donated so far. However, the entire project is costing £900,000, we are therefore looking for partners who believe in the services we provide to help us with the shortfall.





## Money matters

Planning permission has already been granted and work will commence in May 2011, this will run for seven months, completing in time for Christmas.

We still need to raise around £300,000 to pay for this important project. We humbly ask for your support in this.

Would you please consider a donation? If so please complete and return the form below. Thank you.

Full name: \_\_\_\_\_

Address: \_\_\_\_\_

\_\_\_\_\_ Post code: \_\_\_\_\_

Amount donated: £ \_\_\_\_\_ : \_\_\_\_\_

*giftaid it* \*

Gift Aid means that for every pound you give, the project gets an extra 28 pence (25p from April 2011) from HM Revenue & Customs, helping your donation go further, and it doesn't cost you a thing. Just put a tick in the box above.

\* I am a UK taxpayer and I note that I must have paid an amount of income tax or capital gains tax which at least equals tax deducted from this donation.





Leigh Road Baptist Church  
Marguerite Drive  
Leigh-on-Sea  
Essex  
SS9 1NN

Tel: 01702 478698  
Email: [office@lrbc.org.uk](mailto:office@lrbc.org.uk)  
Web: [www.lrbc.org.uk](http://www.lrbc.org.uk)

Registered Charity No. 1128952

